

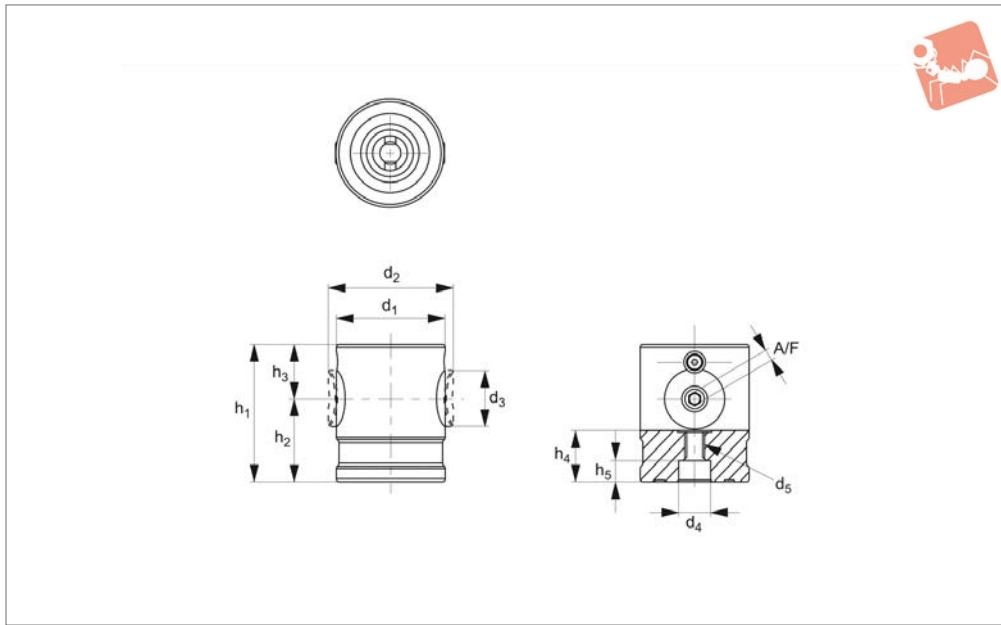

Clamping Module - Single unflanged

Bore Clamping

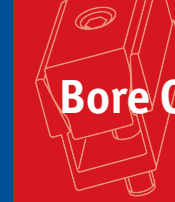

12045

BORE CLAMPING

Material

Steel (AISI 4140), induction hardened, black oxide finish.

Technical Notes

For suitable clamping screws see part no.s

12046 through 12050.

For permissible cutting forces and corresponding workpiece weights when using the clamping module system, see technical pages.

Order No.	h_1 ± 0.01	h_2	h_3	Size	d_1	d_2	d_3	d_4	d_5	h_4	h_5	A/F	Clamping force kN max.	Screw torque Nm max.	Weight g
12045.W0008	32	19.5	12.5	8	30	34.5	15	8	M 6x1,00	11.5	5.0	3	5	4	200
12045.W0011	50	30.0	20.0	11	40	46.0	22	12	M 8x1,25	18.0	7.5	4	8	8	500
12045.W0016	80	50.0	30.0	16	60	69.0	32	18	M12x1,75	25.0	10.5	6	15	22	1600
12045.W0021	100	60.0	40.0	21	80	91.0	44	22	M16x2,00	31.0	12.5	8	25	50	3800