

## 73920

CLAMPING LEVERS

### Material

Case hardened steel, or stainless steel AISI 303. Shaft butt welded.

### Technical Notes

Low price version to no. 74200.

Order No.	Finish	$d_1$	$d_2$	$d_3$	$h_1$	$h_2$ ≈	$l_1$	$l_2$ ≈	Weight g
73920.W0506	Steel	M 8	16	10	12.5	30.5	63	60	39
73920.W0508	Steel	M10	20	12	15.0	37.0	80	76	74
73920.W0510	Steel	M12	25	14	19.0	46.0	100	95	149
73920.W0512	Steel	M16	32	18	25.0	58.5	125	119	316
73920.W0516	Steel	M20	40	20	31.0	73.0	160	152	533
73920.W0606	Stainless Steel	M 8	16	10	12.5	30.5	63	60	39
73920.W0608	Stainless Steel	M10	20	12	15.0	37.0	80	76	73
73920.W0610	Stainless Steel	M12	25	14	19.0	46.0	100	95	153
73920.W0612	Stainless Steel	M16	32	18	25.0	58.5	125	119	314
73920.W0616	Stainless Steel	M20	40	20	31.0	73.0	160	152	533



**73922**

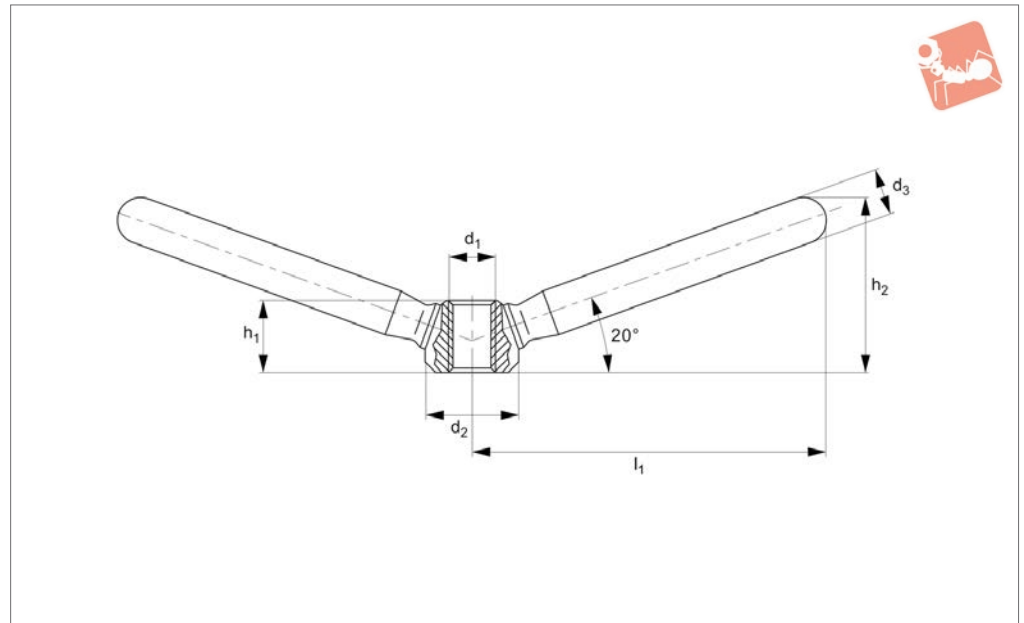

**Material**

Steel, galvanised.  
Stainless steel 1.4301, dull blasted.

**Technical Notes**

Allows for two-handed operating.

Order No.	Material	d <sub>1</sub>	d <sub>2</sub>	d <sub>3</sub>	h <sub>1</sub>	h <sub>2</sub>	l <sub>1</sub> ≈	Weight g
73922.W0706	Steel	M 8	16	10	12.5	26	47.5	55
73922.W0708	Steel	M10	20	12	15.0	32	59.5	116
73922.W0710	Steel	M12	25	14	19.0	40	75.5	210
73922.W0712	Steel	M16	32	18	25.0	52	94.5	432
73922.W0716	Steel	M20	40	20	31.0	62	118.0	716
73922.W0806	Stainless Steel	M 8	16	10	12.5	26	47.5	55
73922.W0808	Stainless Steel	M10	20	12	15.0	32	59.5	116
73922.W0810	Stainless Steel	M12	25	14	19.0	40	75.5	210
73922.W0812	Stainless Steel	M16	32	18	25.0	52	94.5	432
73922.W0816	Stainless Steel	M20	40	20	31.0	62	118.0	716

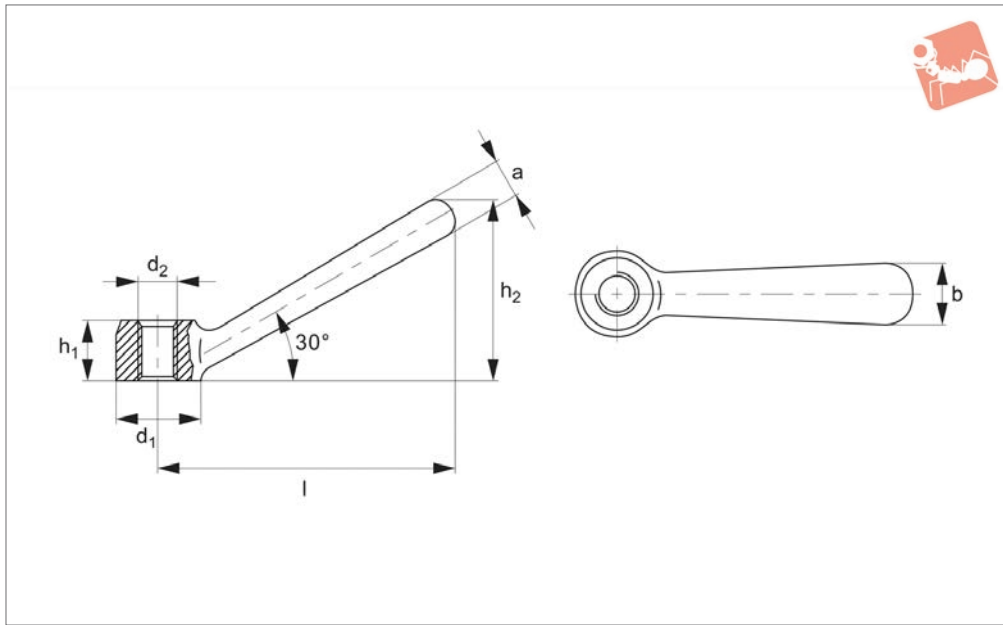

**74000**

CLAMPING LEVERS

### Material

Malleable iron, tumble finish. Contact faces machined.

### Technical Notes

These economic clamping levers are ideal where a lacquered finish is required.

Order No.	a	b	d <sub>1</sub>	d <sub>2</sub>	h <sub>1</sub>	h <sub>2</sub> ≈	l ≈	Weight g
74000.W0008	7	12	16	M 8	12	34.0	56	34
74000.W0010	9	14	20	M10	14	42.5	70	60
74000.W0012	11	18	25	M12	18	53.0	87	125
74000.W0016	15	22	32	M16	22	66.5	109	248
74000.W0020	18	28	40	M20	28	84.5	140	518



**74100**

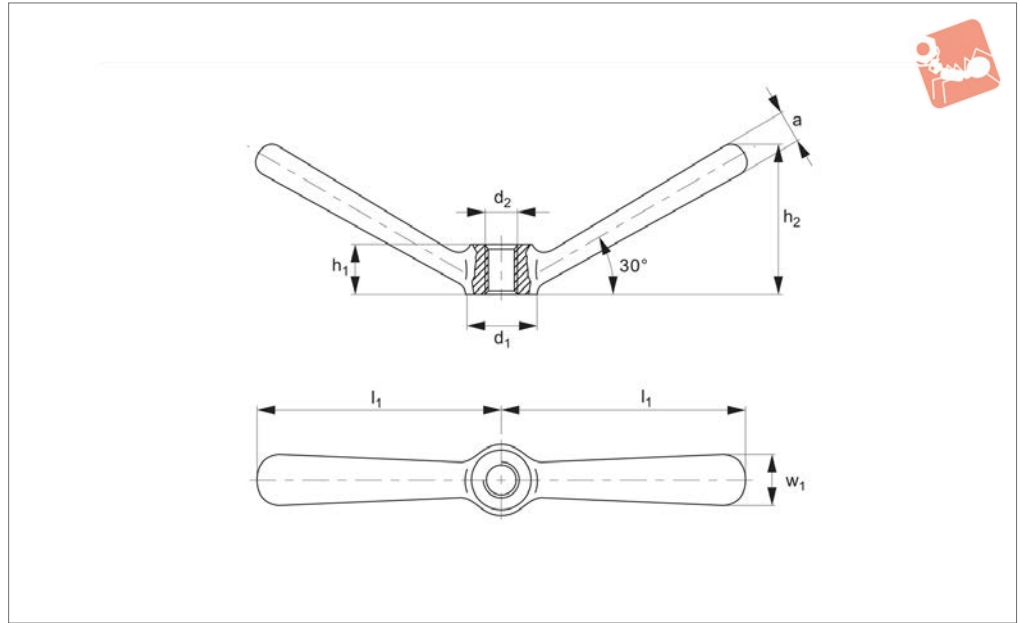

**Material**

Malleable iron, prepared and tumble finished. Contact faces machined.

**Technical Notes**

Clamping levers with double arms are robust. Applications are, for example, in

boiler making and special purpose machinery.

Order No.	a	d <sub>1</sub>	d <sub>2</sub>	h <sub>1</sub>	h <sub>2</sub> ≈	l <sub>1</sub> ≈	w <sub>1</sub>	Weight g
74100.W0008	7	16	M 8	12	34	56	12	55
74100.W0010	9	20	M10	14	42	70	14	104
74100.W0012	11	25	M12	18	53	87	18	213
74100.W0016	15	32	M16	22	66	109	22	429
74100.W0020	18	40	M20	28	84	140	28	820

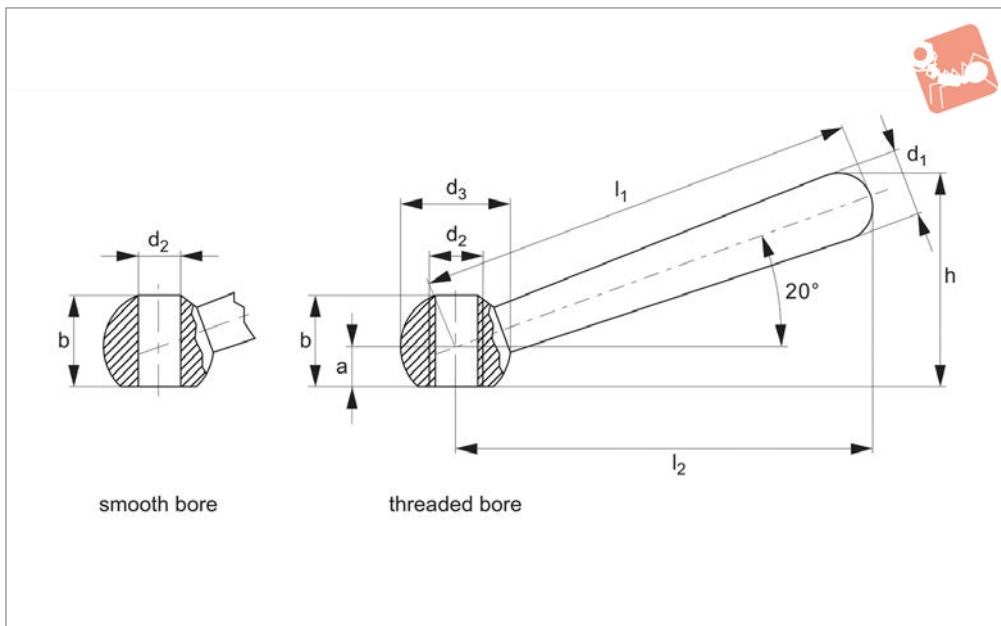

**74200**

CLAMPING LEVERS

### Material

Steel, blackened.

Order No.	Finish	a	b ≈	$d_1$	$d_2$ tol. H7	$d_2$	$d_3$	h ≈	$l_1$	$l_2$ ≈	Weight g
<b>74200.W0105</b>	Smooth Bore	4.0	9.5	8	6	-	12	24.0	50	48	16
<b>74200.W0106</b>	Smooth Bore	5.0	12.0	10	8	-	16	30.5	63	60	37
<b>74200.W0108</b>	Smooth Bore	6.0	14.5	13	10	-	20	38.0	80	76	73
<b>74200.W0110</b>	Smooth Bore	7.5	18.5	16	12	-	25	47.0	100	95	140
<b>74200.W0112</b>	Smooth Bore	10.0	24.0	20	16	-	32	59.5	125	119	282
<b>74200.W0116</b>	Smooth Bore	12.5	30.0	25	20	-	40	75.7	160	152	553
<b>74200.W0120</b>	Smooth Bore	18.0	40.0	32	24	-	50	97.0	200	190	1096
<b>74200.W0305</b>	Threaded Bore	4.0	9.5	8	-	M 6	12	24.0	50	48	17
<b>74200.W0306</b>	Threaded Bore	5.0	12.5	10	-	M 8	16	30.5	63	60	38
<b>74200.W0308</b>	Threaded Bore	6.0	15.0	13	-	M10	20	38.0	80	76	74
<b>74200.W0310</b>	Threaded Bore	7.5	19.0	16	-	M12	25	47.0	100	95	142
<b>74200.W0312</b>	Threaded Bore	10.0	25.0	20	-	M16	32	59.5	125	119	297
<b>74200.W0316</b>	Threaded Bore	12.5	31.0	25	-	M20	40	75.7	160	152	566
<b>74200.W0320</b>	Threaded Bore	18.0	41.0	32	-	M24	50	97.0	200	190	1140



**74201**

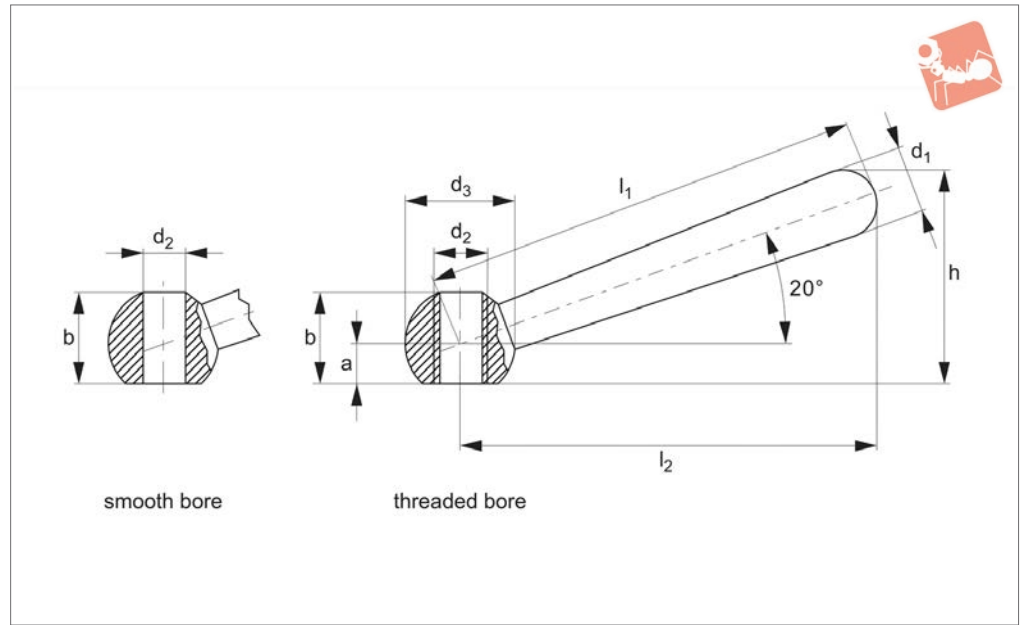

### Material

Stainless steel 1.4305 (AISI 303), dull blasted.

Order No.	Finish	a	b	$d_1$	$d_2$ tol. H7	$d_2$	$d_3$	h	$l_1$	$l_2$	Weight g
74201.W0206	Smooth Bore	5.0	12.0	10	8	-	16	30.5	63	60	37
74201.W0208	Smooth Bore	6.0	14.5	13	10	-	20	38.0	80	76	73
74201.W0210	Smooth Bore	7.5	18.5	16	12	-	25	47.0	100	95	140
74201.W0405	Threaded Bore	4.0	9.5	8	-	M_6	12	24.0	50	48	17
74201.W0406	Threaded Bore	5.0	12.5	10	-	M_8	16	30.5	63	60	38
74201.W0408	Threaded Bore	6.0	15.0	13	-	M10	20	38.0	80	76	74
74201.W0410	Threaded Bore	7.5	19.0	16	-	M12	25	47.0	100	95	142
74201.W0412	Threaded Bore	10.0	25.0	20	-	M16	32	59.5	125	119	297

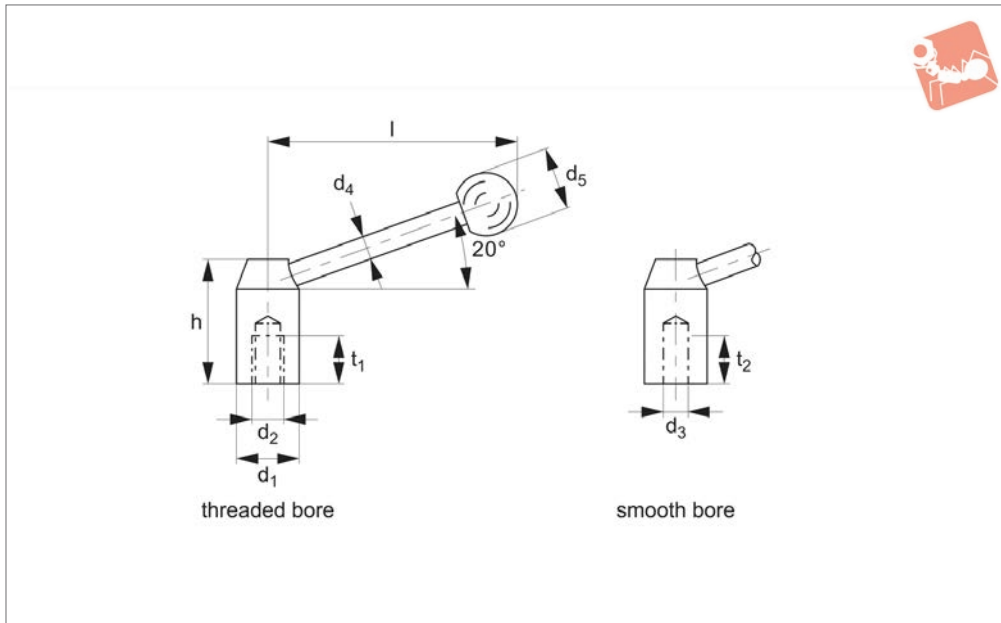

**74300**

CLAMPING LEVERS

### Material

Handle: free-cutting steel, finish-turned or ground, blackened.

Ball knob: plastic type 31 black.

Order No.	Finish	$d_1$	$d_2$	$d_3$ tol. H7	$d_4$	$d_5$	$h$	$l$ $\approx$	$t_1$	$t_2$	Weight g
74300.W0022	Threaded Bore	20	M 8	-	8	20	33	65	15	-	97
74300.W0032	Threaded Bore	22	M10	-	8	20	37	82	15	-	113
74300.W0038	Threaded Bore	25	M12	-	10	25	42	96	18	-	165
74300.W0042	Threaded Bore	28	M12	-	12	30	47	110	18	-	262
74300.W0048	Threaded Bore	32	M16	-	12	32	52	124	23	-	354
74300.W0052	Threaded Bore	36	M16	-	14	35	58	138	24	-	519
74300.W0058	Threaded Bore	40	M20	-	16	40	64	152	27	-	715
74300.W0020	Smooth Bore	20	-	10	8	20	33	67	-	16	91
74300.W0030	Smooth Bore	22	-	10	8	20	37	82	-	18	117
74300.W0035	Smooth Bore	25	-	12	10	25	42	96	-	21	170
74300.W0040	Smooth Bore	28	-	12	12	30	47	110	-	22	268
74300.W0045	Smooth Bore	32	-	16	12	32	52	124	-	25	351
74300.W0050	Smooth Bore	36	-	16	14	35	58	138	-	26	524
74300.W0055	Smooth Bore	40	-	20	16	40	64	152	-	29	700



## 74301

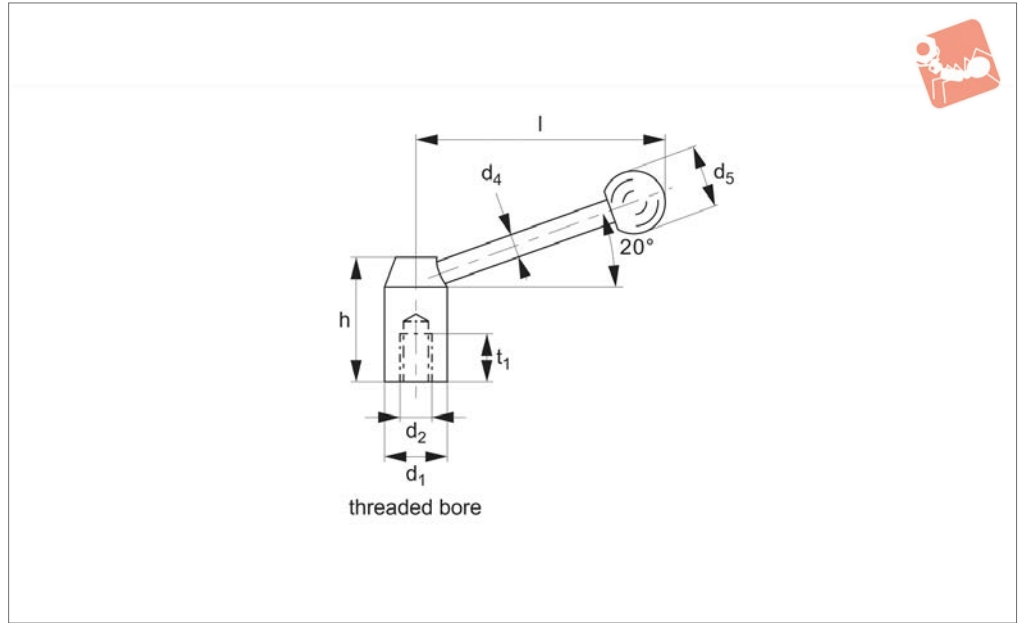

**Material**

Handle: stainless steel 1.4305 (AISI 303).  
Dull blasted.

Ball knob: plastic type 31 black.

Order No.	Finish	d <sub>1</sub>	d <sub>2</sub>	d <sub>4</sub>	d <sub>5</sub>	h	l	t <sub>1</sub>	Weight g
<b>74301.W0230</b>	Threaded Bore	22	M 8	8	20	37	70	15	121
<b>74301.W0236</b>	Threaded Bore	25	M10	10	25	42	96	15	186
<b>74301.W0242</b>	Threaded Bore	28	M12	12	30	47	110	18	262
<b>74301.W0248</b>	Threaded Bore	32	M16	12	32	52	124	23	354