

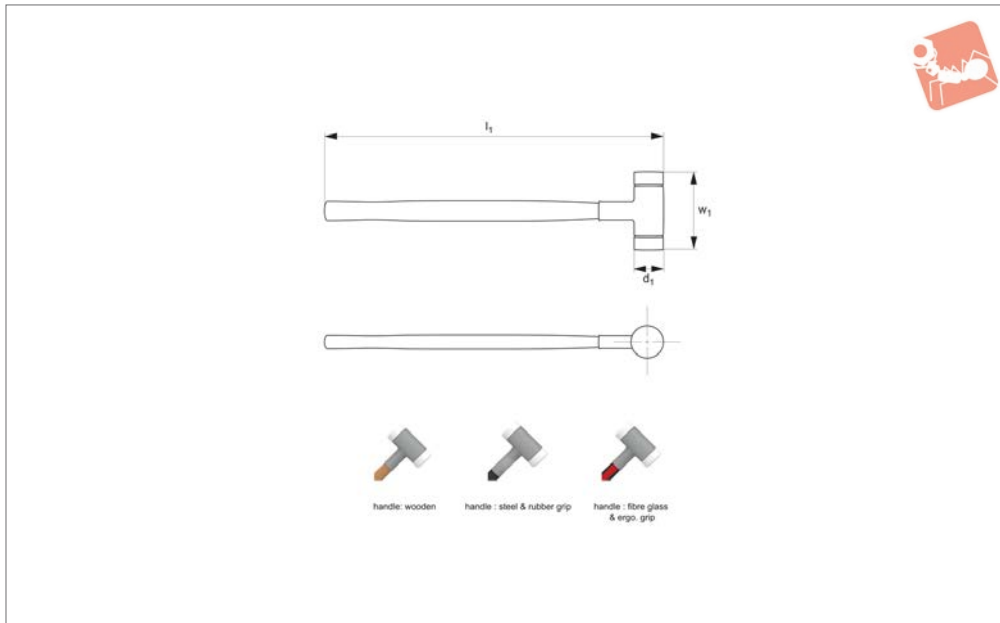

Non-Rebound Mallets - Complete with nylon inserts



Mallets & Hammers



98301

MALLETS & HAMMERS

Material

Housing: steel, shot filled.
 Inserts: nylon, made from extruded tube material.
 Handle: wood, fibreglass or steel. Steel and fibreglass handles include rubber grip.

Technical Notes

Shot filled housing results in a non-rebound action and assists in full transmission of impact force.
 Inserts are replaceable.

Tips

Both handle and inserts can be replaced.
 For replacement items see;
 - handle no. 98302
 - inserts no. 98303

Order No.	Handle type	Ø d ₁	w ₁	l ₁	Weight g
98301.W0020	Wood	20	105	300	245
98301.W0025	Wood	25	105	305	325
98301.W0030	Wood	30	110	330	460
98301.W0035	Wood	35	110	335	560
98301.W0040	Wood	40	115	360	715
98301.W0045	Wood	45	120	365	830
98301.W0050	Wood	50	120	370	990
98301.W0060	Wood	60	145	370	1705
98301.W0070	Wood	70	150	370	2215
98301.W0080	Wood	80	168	380	3210
98301.W0125	Steel	25	105	270	385
98301.W0130	Steel	30	110	290	585
98301.W0135	Steel	35	110	295	690
98301.W0140	Steel	40	115	300	805
98301.W0145	Steel	45	120	305	935
98301.W0150	Steel	50	120	310	1150
98301.W0160	Steel	60	145	325	1750
98301.W0170	Steel	70	150	335	2250
98301.W0240	Fibreglass	40	116	370	790
98301.W0250	Fibreglass	50	120	380	1040
98301.W0260	Fibreglass	60	145	390	1625

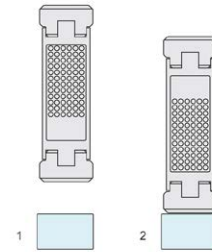
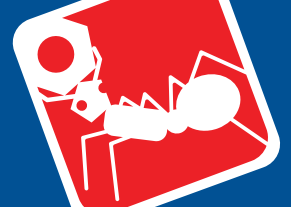
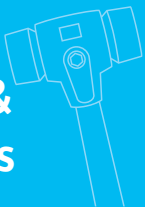

diagram showing the shot-filled housing of the non-rebound mallet



Handle - for Non-Rebound Mallets

wood - for no. 98301



Mallets & Hammers

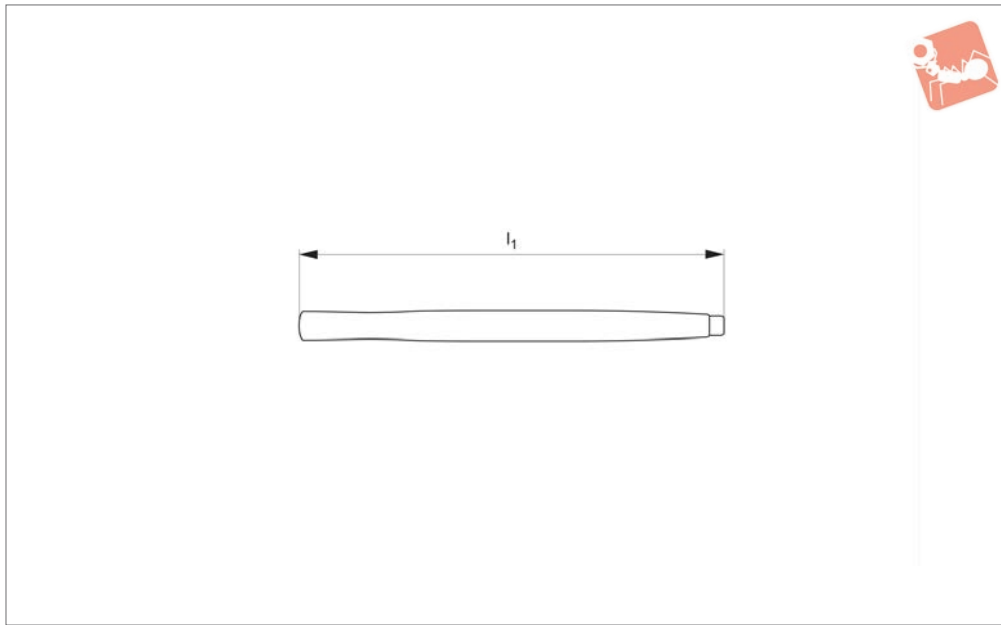

98302

MALLETS & HAMMERS

Material

Hickory wood.

Order No.	For mallet head dia. d_1	l_1
98302.W0320	20	280
98302.W0325	25	280
98302.W0330	30/35	300
98302.W0340	40/45/50	315
98302.W0360	60/70/80	300

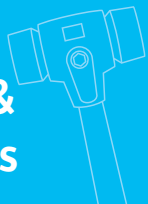

98303

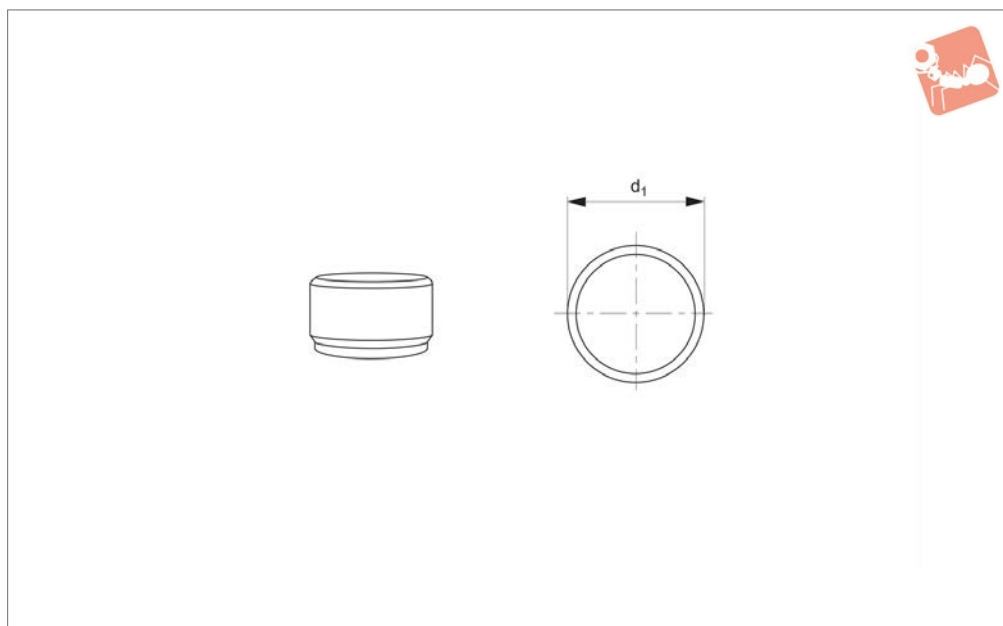

Material

Nylon, white.

Order No.	For mallet head dia. d_1	Insert type
98303.W0420	20	Nylon - White
98303.W0425	25	Nylon - White
98303.W0430	30	Nylon - White
98303.W0435	35	Nylon - White
98303.W0440	40	Nylon - White
98303.W0445	45	Nylon - White
98303.W0450	50	Nylon - White
98303.W0460	60	Nylon - White
98303.W0470	70	Nylon - White
98303.W0480	80	Nylon - White

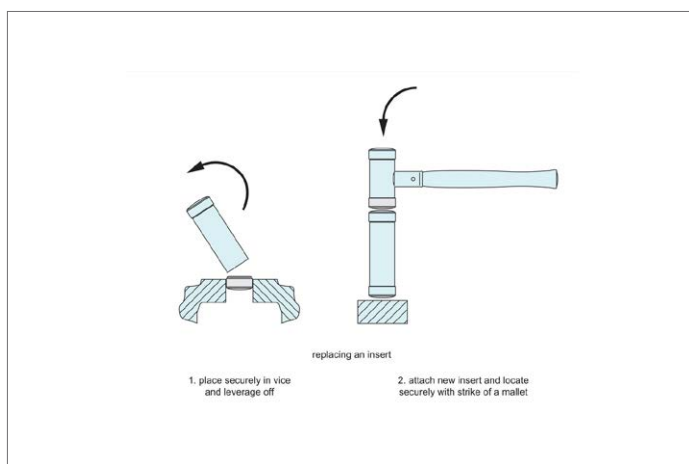



Non-Rebound Mallets - Complete steel housing and handle

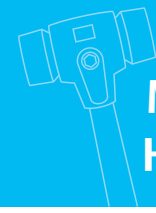

Mallets & Hammers

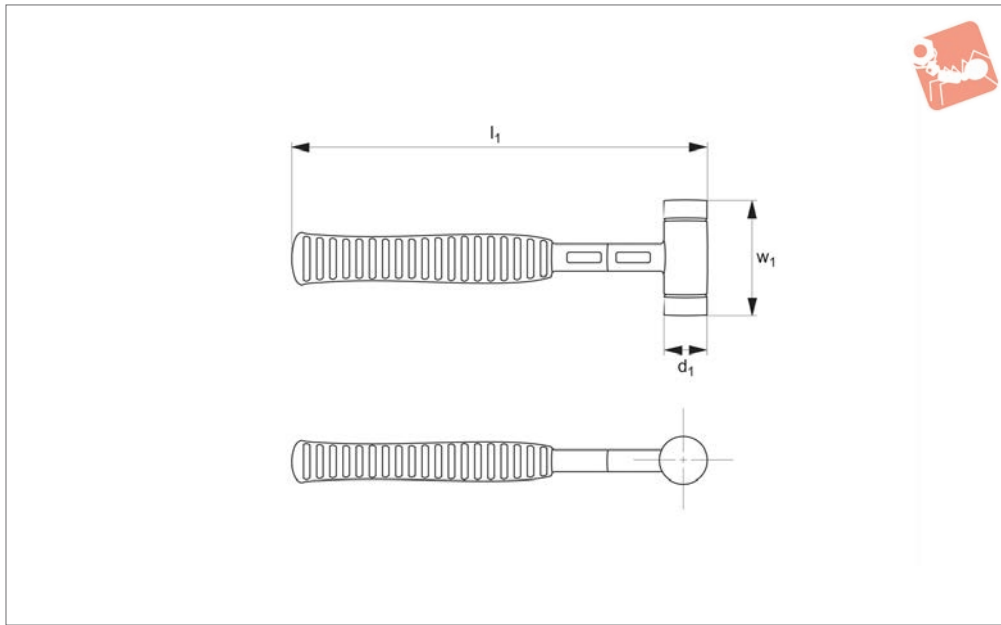

98310

MALLETS & HAMMERS

Material

Housing: steel, polyurethane coating.
Handle: steel, ergonomic rubber grip.

rebound action and assists in full transmission of impact force.

workpieces in vices, sheet-metal working, dent removal.

Technical Notes

Shot filled housing results in a non-

Tips

Ideal for uses including: automobile assembly and repair work, positioning of

Order No.	$\varnothing d_1$	w_1	l_1	Weight g
98310.W0040	40	110	300	640
98310.W0050	50	115	310	900
98310.W0060	60	120	315	1300

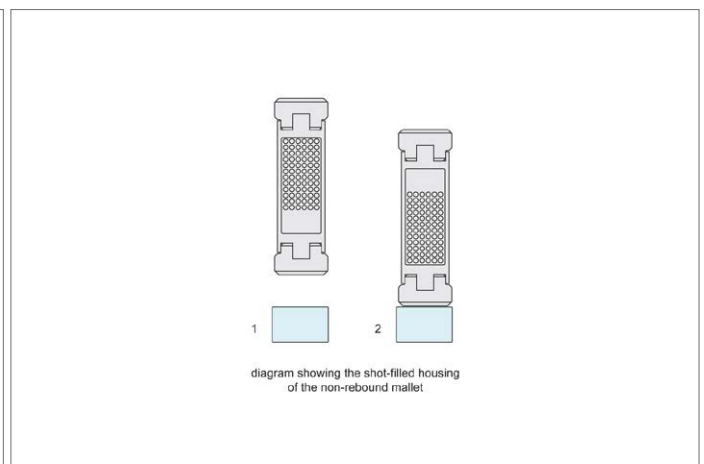
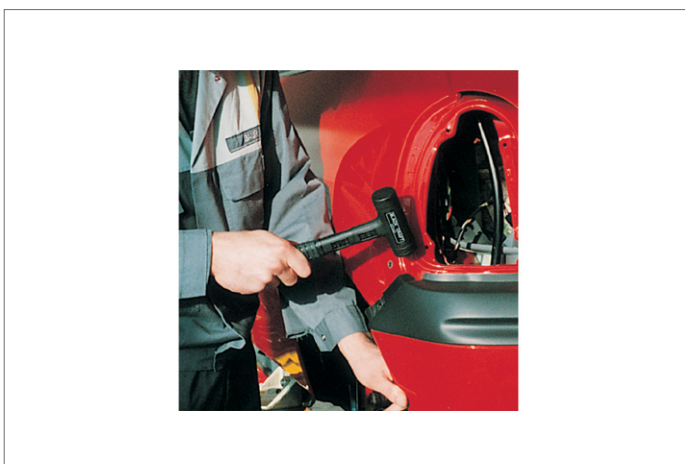



98321

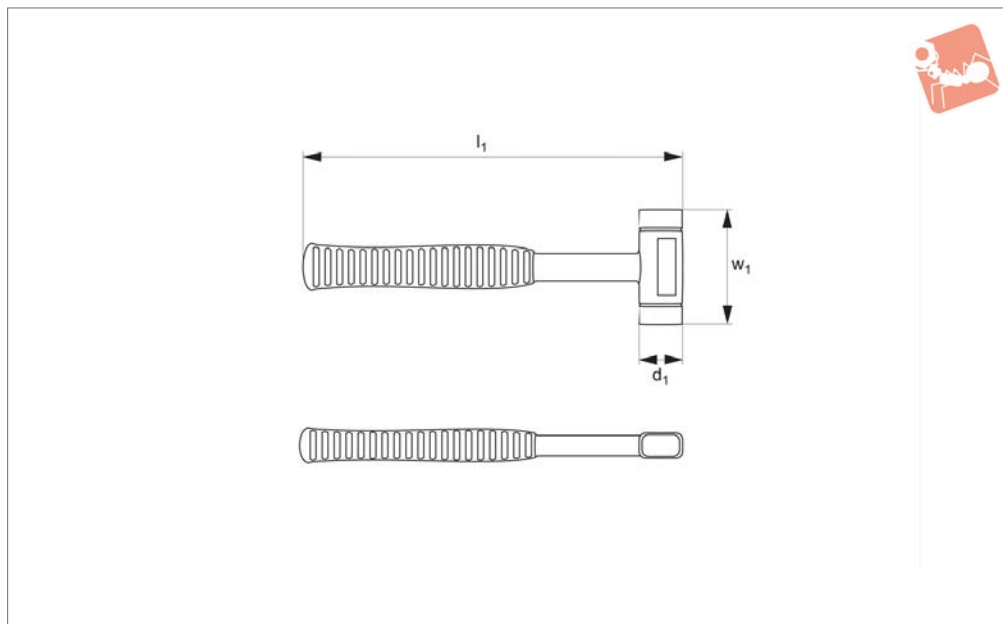

Material

Housing: from cut steel plate.
 Handle: sheet metal, ergonomic rubber grip.
 Inserts: polyurethane, yellow. Medium hard.

Technical Notes

Shot filled housing results in a non-rebound action and assists in full transmission of impact force.
 Inserts are replaceable.

Tips

For replacement inserts see;
 - inserts no. 98322

Order No.	d_1	w_1	l_1	Weight g
98321.W0040	30x40	117	300	680

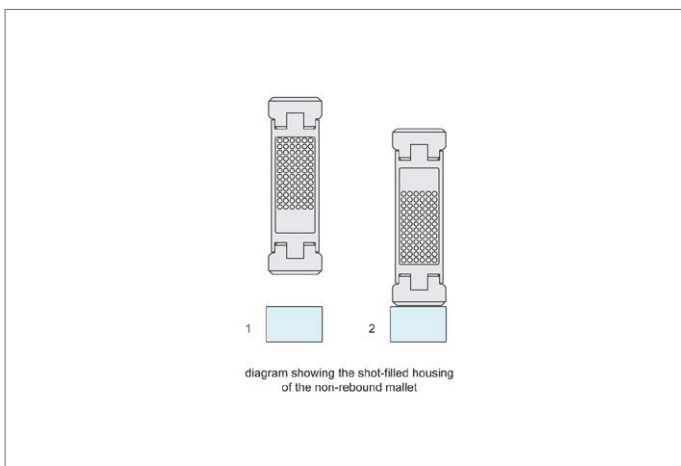



Inserts - for Non-Rebound Mallets

for no. 98321

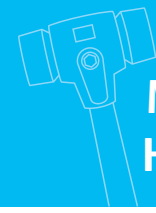

Mallets & Hammers

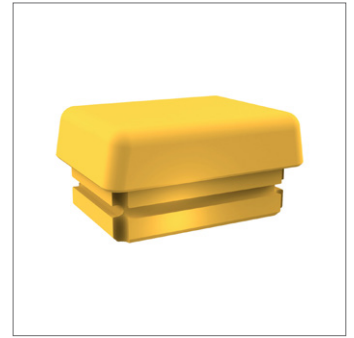
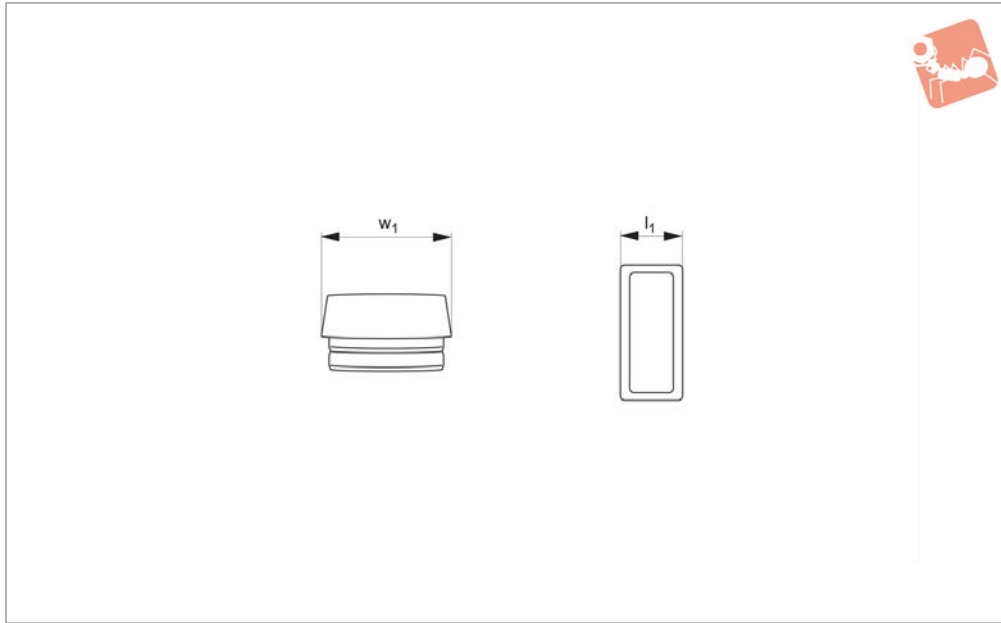

98322

MALLETS & HAMMERS

Material

Polyurethane, yellow.

Technical Notes

Replacement inserts for secural mallet, part no. 98321.

Order No.
98322.W0141

For mallet size $l_1 \times w_1$
30x40

Insert type
Polyurethane



98330

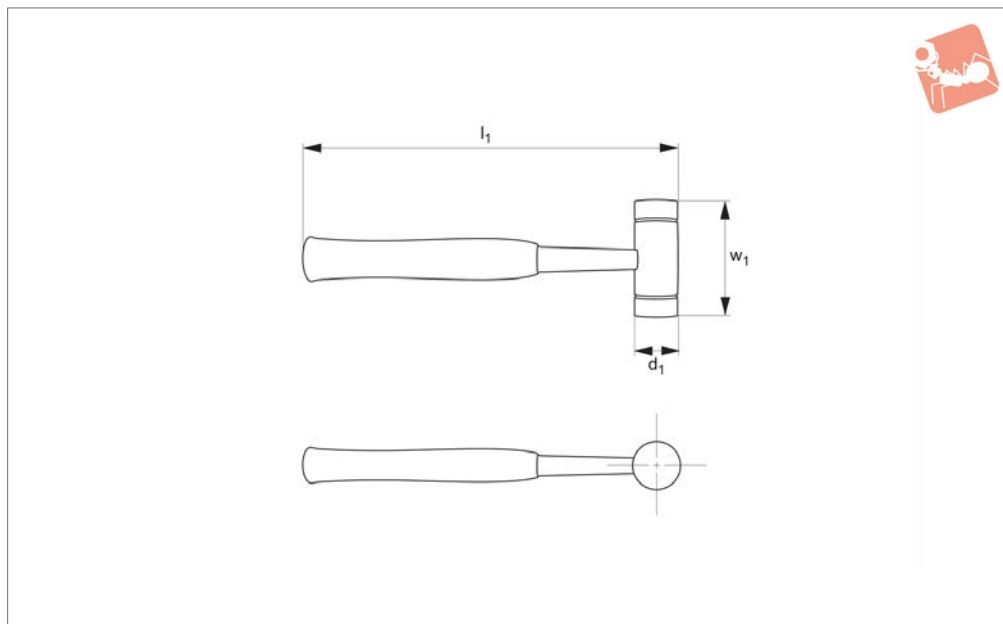

Material

Head: steel.
 Handle: steel tube, with rubber grip.
 Hammer faces: 1 x heat treated steel, induction hardened. 1 x nylon, white.

Technical Notes

Nylon insert can be replaced, see replacement part nos. 98363.W0480 and 98363.W0482.

Tips

For replacement nylon insert see; - inserts no. 98363

Order No.	$\varnothing d_1$	w_1	l_1	Weight g
98330.W0030	30	104	290	600
98330.W0035	35	104	295	800





Non-Rebound Sledge Hammer

steel housing - wooden handle - complete



Mallets & Hammers

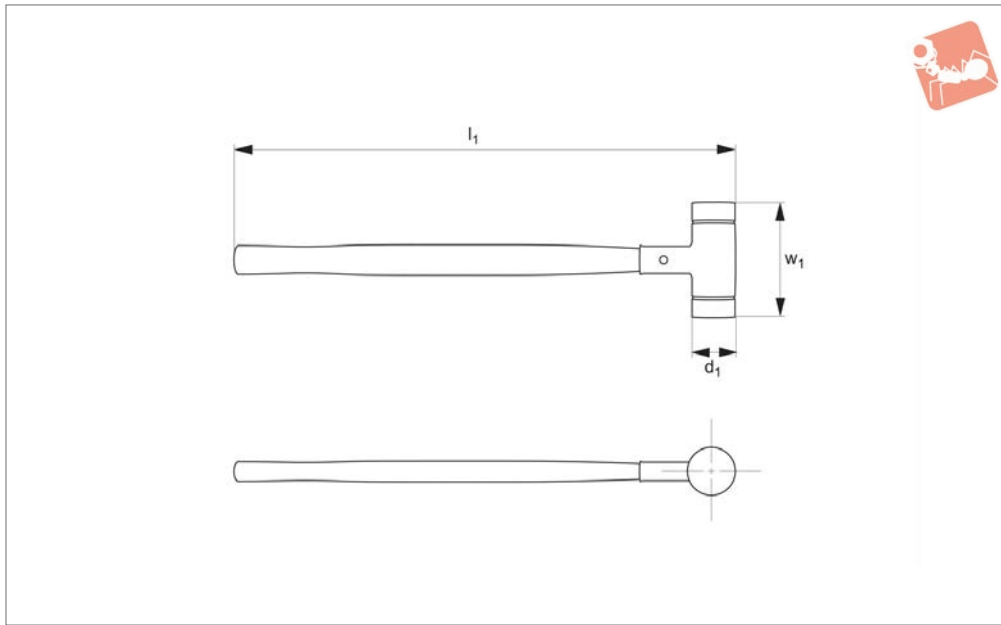

98361

MALLETS & HAMMERS

Material

Housing: steel, shot filled.

Inserts: nylon, made from extruded tube material.

Handle: wood.

Technical Notes

Shot filled housing results in a non-

rebound action and assists in full transmission of impact force.

Inserts are replaceable see part no. 98363.

Tips

Both handle and inserts can be replaced.

For replacement items see;

- handle no. 98362

- inserts no. 98363

Order No.	Insert type	$\varnothing d_1$	w_1	l_1	Weight g
98361.W0080	Nylon	80	200	880	4410
98361.W0100	Nylon	100	210	1000	7050
98361.W0120	Nylon	100	265	1000	9300

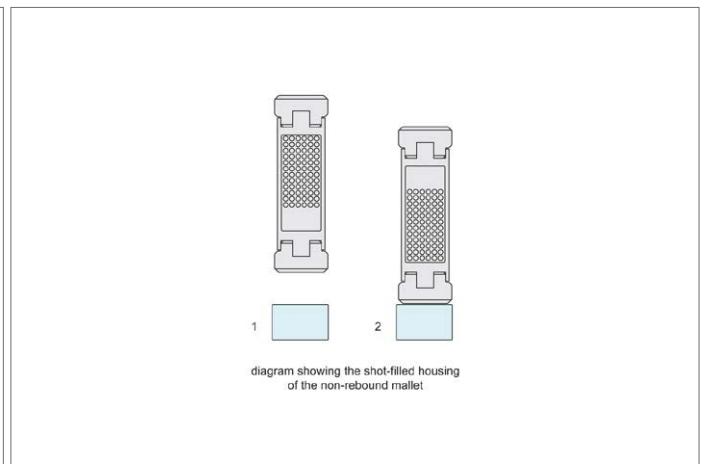

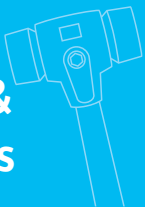

98362

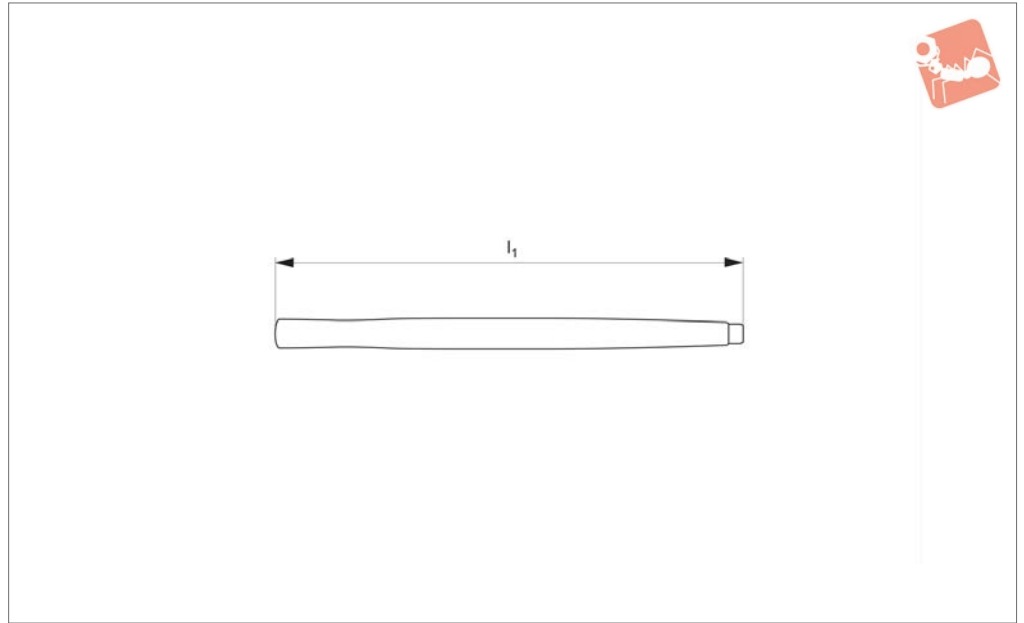

Material
Wood.

Order No.	For mallet head dia. d_1	l_1
98362.W0381	80	800
98362.W0382	100	900

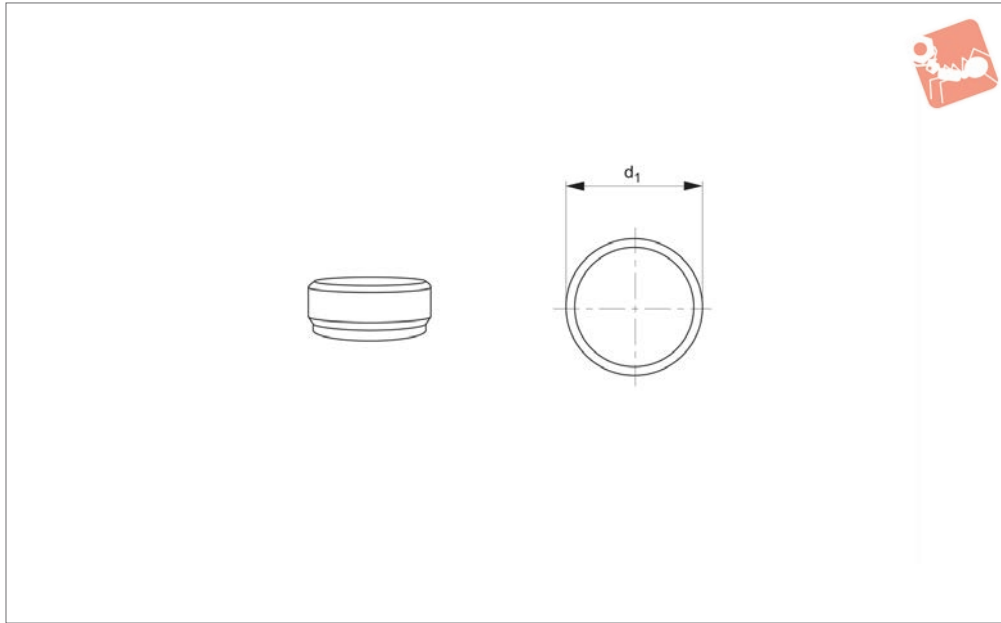

98363

MALLETS & HAMMERS

Material

Nylon, white.

Order No.	For mallet head dia. d_1	Insert type
98363.W0480	80	Nylon - White
98363.W0482	100	Nylon - White

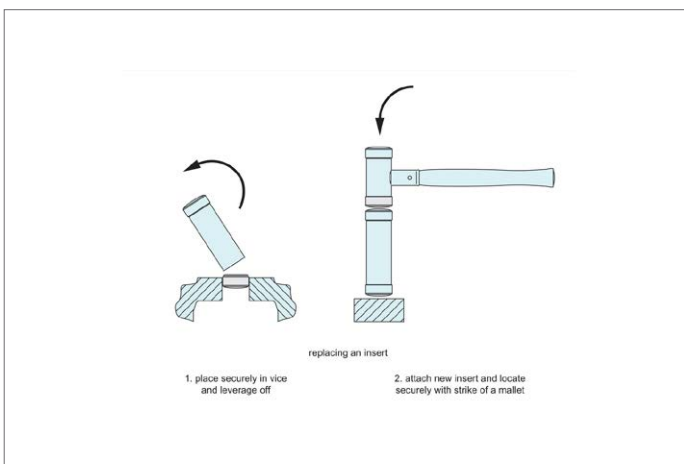



Application Selection Chart

MAJETS & HAMMERS

Application selection chart

TPE-soft	Composite rubber	TPE-mid	Plastic	Super plastic	Nylon	Alu	Copper	98301 wood	98301 steel	98301 fibre	98310	98321	98401	98330
Soft	Med	Med	Hard	Med	Hard	Hard	Hard							
Range of inserts for Simplex mallets 98001 to 98224								Range of mallet handle types						

Construction applications

Paving		•	•		•										
Floor tiling	•		•												
Curbstone setting / Masonry work		•			•										
Concrete form set-up		•		•											
Scaffold construction		•		•	•	•									
Tent and hall construction					•	•		•							
Gardening and landscaping		•			•										
Home construction		•	•												

Metal-working industry applications

Automotive assembly and repair work				•	•	•	•	•	•	•	•	•	•	•	•
Positioning of workpieces in a vice								•	•	•	•	•	•		
Straightening work						•		•	•	•	•				
Joining of workpieces						•		•	•	•	•			•	•
Repair and maintenance work				•			•	•	•	•	•			•	•
Car body work				•	•		•	•	•	•	•	•	•	•	•
Sheet metal working				•	•	•		•	•	•	•	•	•		•
Dent removal	•	•		•	•	•					•	•	•	•	•
Housing assembly					•	•		•	•	•		•	•	•	•
Mould construction						•	•								•
Assembly of sharp-edged workpieces					•	•		•	•	•					•

Wood-working applications

Furniture assembly	•		•										•		•
Window and door construction	•		•										•		•
Prefabricated house construction		•													
Joiner's work	•		•										•		•
Carpenter's work		•													
Floor parqueting / laminating													•		

Agriculture and forestry applications

Fence construction		•			•			•							
Wood splitting with wedge					•			•							
Maintenance and repair work on agricultural machinery						•		•							•